

SNOWBEAR[®]

324-128
Drop Kit
Installation
Instruction

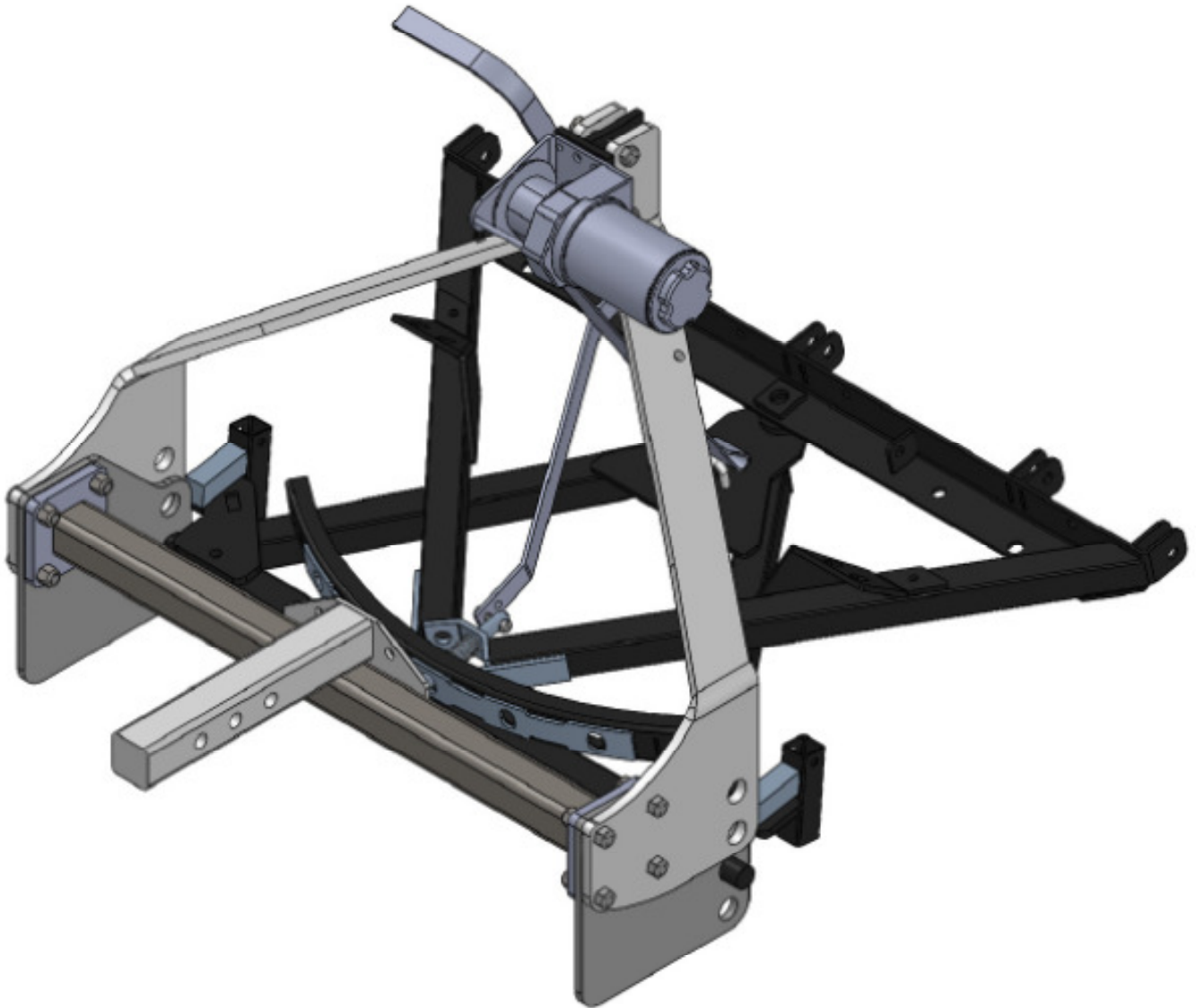

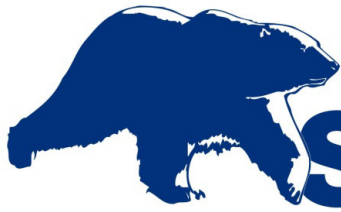

Safety Precautions - Read Before Installation



DISCONNECT POWER BEFORE INSTALLATION. Disconnect Plow power cord from vehicle plug before attempting to install Drop Kit. Failure to do so could result in injury if Plow Winch should be activated.



ONLY USE SNOWBEAR® CERTIFIED PARTS AND ACCESSORIES. Consult the owner's manual for the recommended accessories and/or replacement parts. The use of improper accessories and/or replacement parts may cause hazards and void applicable warranties.





REMOVE IGNITION KEY, PUT VEHICLE IN PARK. In order to prevent others from starting vehicle or vehicle from moving while Drop Kit is being installed, remove key from ignition and put vehicle in park or in gear.



RECOMMENDED 2 PERSON INSTALLTION. It is recommended that 2 people perform this installation as it requires some lifting of heavy objects/assemblies and a need to align holes to install hardware.

Assembly tool list

	Ratcheting Wrench
	3/4" Socket (x2)
	OR 3/4" Open Ended/Box Wrench (x2)

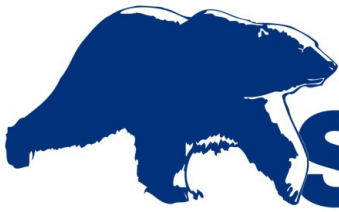

INSTALLATION:

The SnowBear® Drop Kit is designed to quickly and easily install on your SnowBear® SP115 Plow Assembly.

If installed on your vehicle, the plow assembly does not need to be removed. The 2" Hitch Receiver weldment can remain while the installation is performed.

Step 1

Remove the 1/2"-13 hex bolts & nuts (4 per side) that fasten the Left Hand and Right Hand Winch Arms to the Winch Assembly with 3/4" ratcheting wrench/socket(s) and/or open/box end wrench(es).

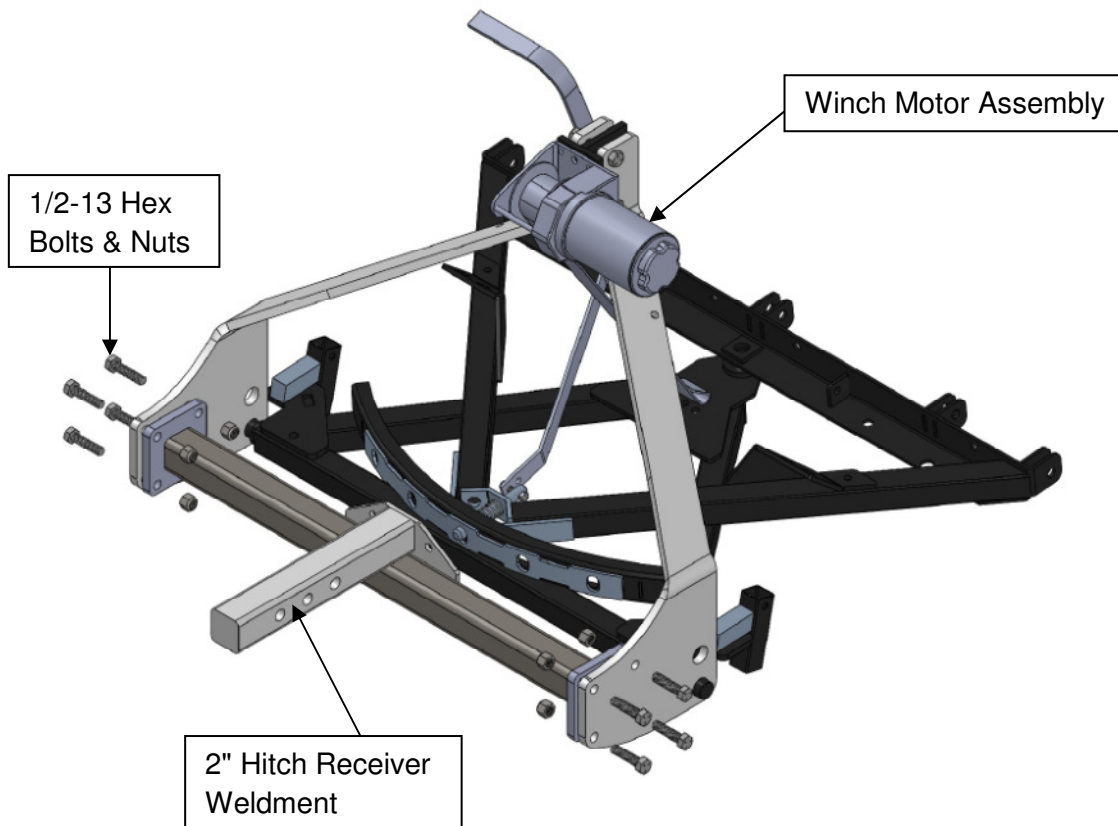

Caution!!

It is recommended that 2 people hold the Winch Arm & A-Frame assembly as it will drop after the bolts are removed OR Have a means to prop the assemblies up to maintain position.

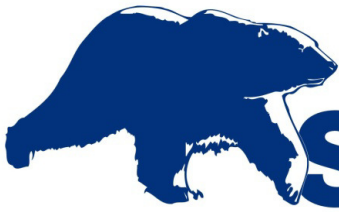

Step 2:

Loosen (do not fully remove) 1/2"-13 bolts & nuts that hold the Winch Arms to the Winch Motor Assembly bracket. This will allow the Winch Arms to disengage the Lower A-Frame Weldment pins. A-Frame Weldment is free to drop.

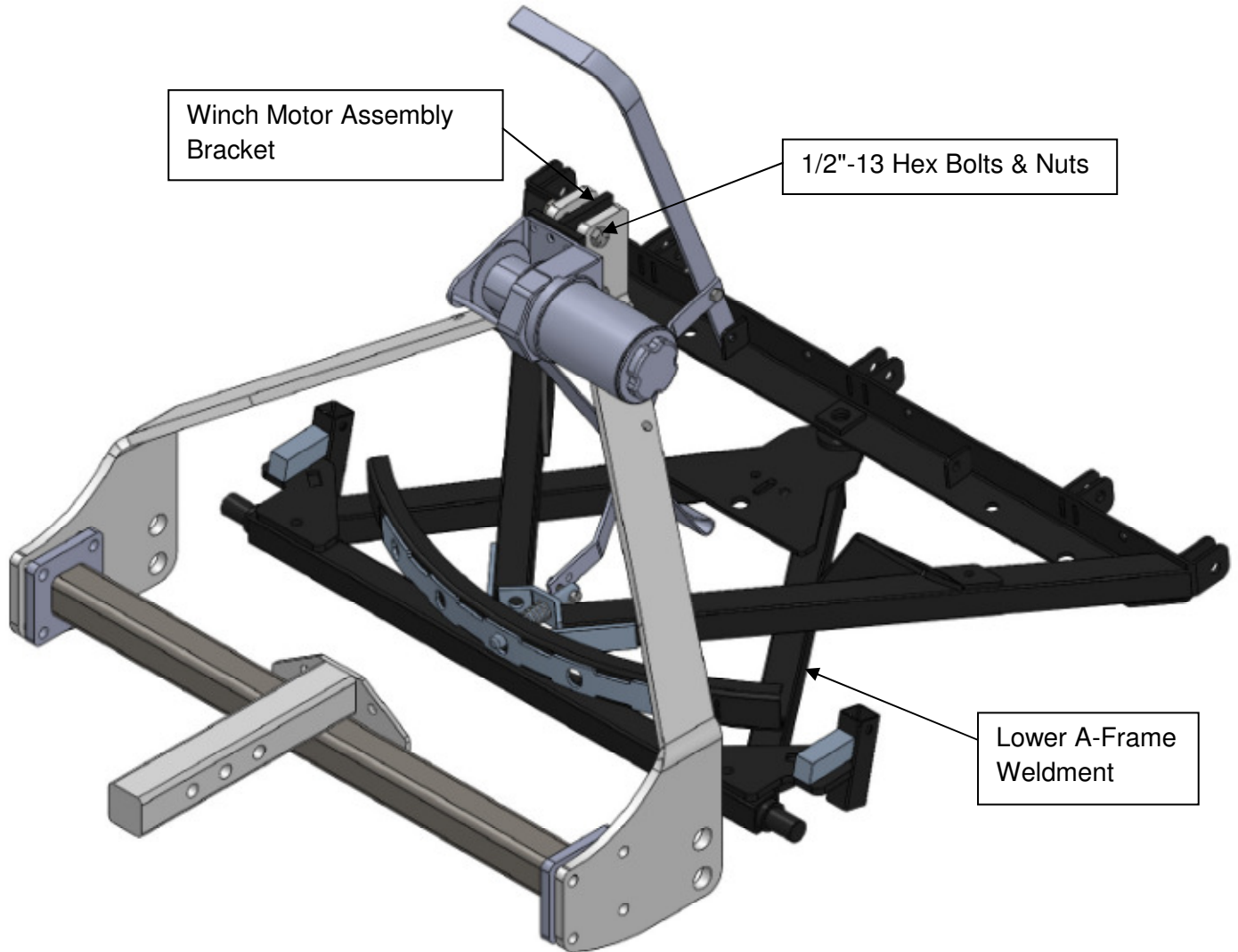

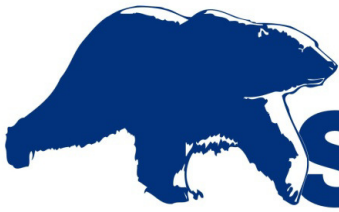

Step 3:

Install single Drop Kit Plate as shown in below diagram. Only do one side (Left or Right) only at this time (Left side shown). Install Drop Kit Plate between Winch Arm & Receiver Weldment with 1/2"-13 x 2" Hex Bolts & Nuts (as supplied in Hardware Kit) (x4). Fasten hardware completely.

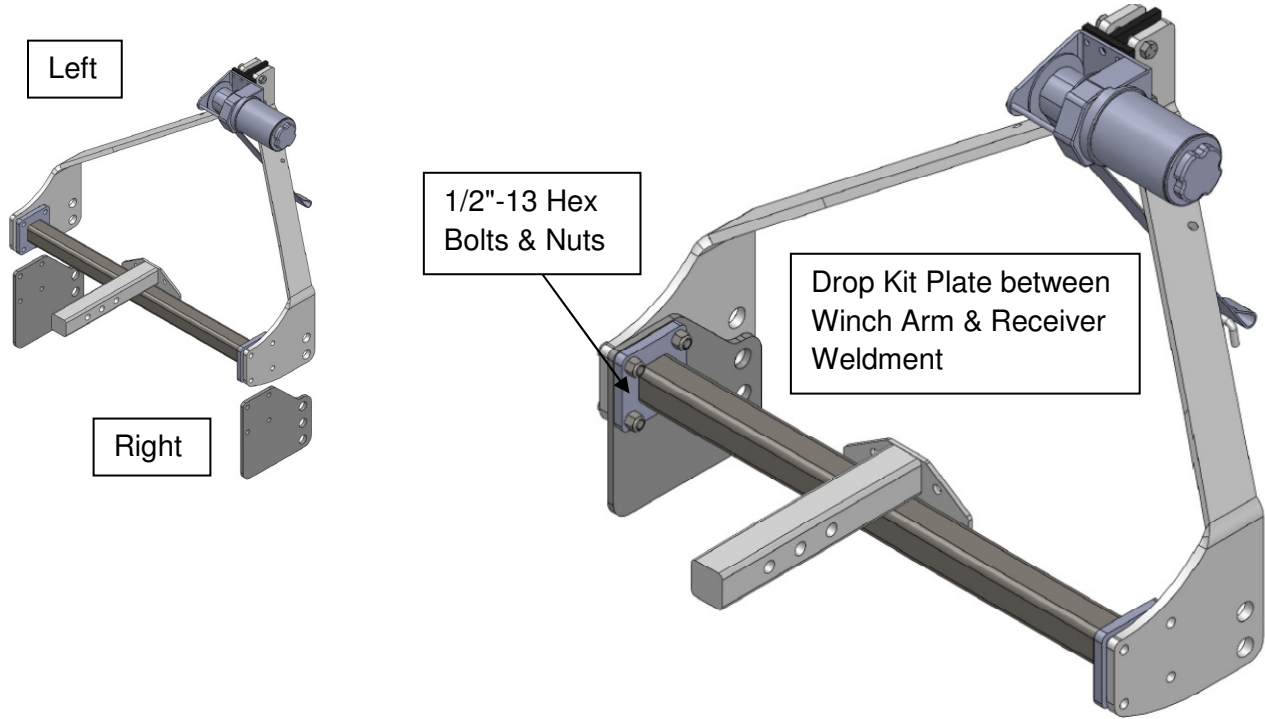

Step 4:

Install A-Frame Weldment into one of the two lower holes on the Drop Kit Plate on the side installed.

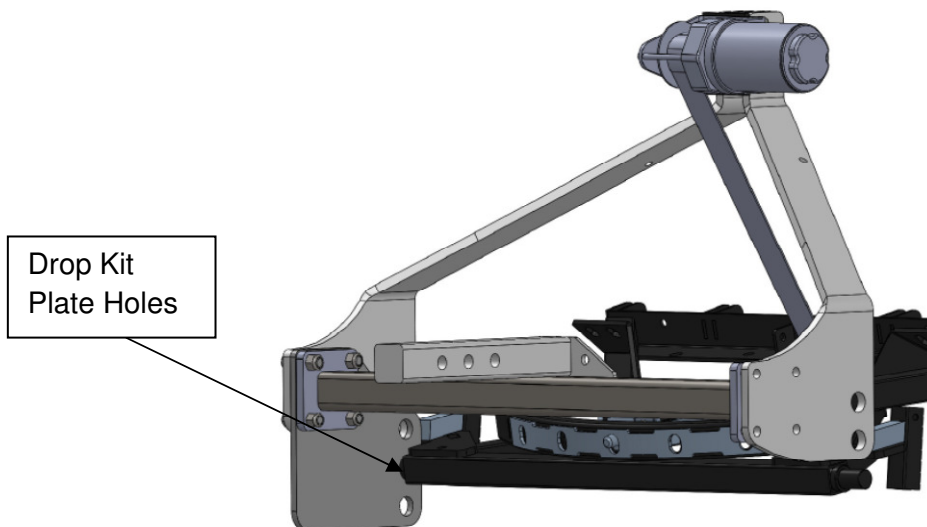

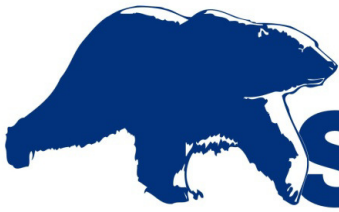

Step 5:

Install remaining Drop Kit Plate on pin of A-Frame Weldment in the same hole as on opposite side. Slide Drop Kit Plate between Winch Arm & Receiver Weldment and install 1/2"-13 x 2" Hex Bolts & Nuts (supplied in Hardware Kit) and tighten completely. Tighten all hardware at the Winch Motor Assembly.

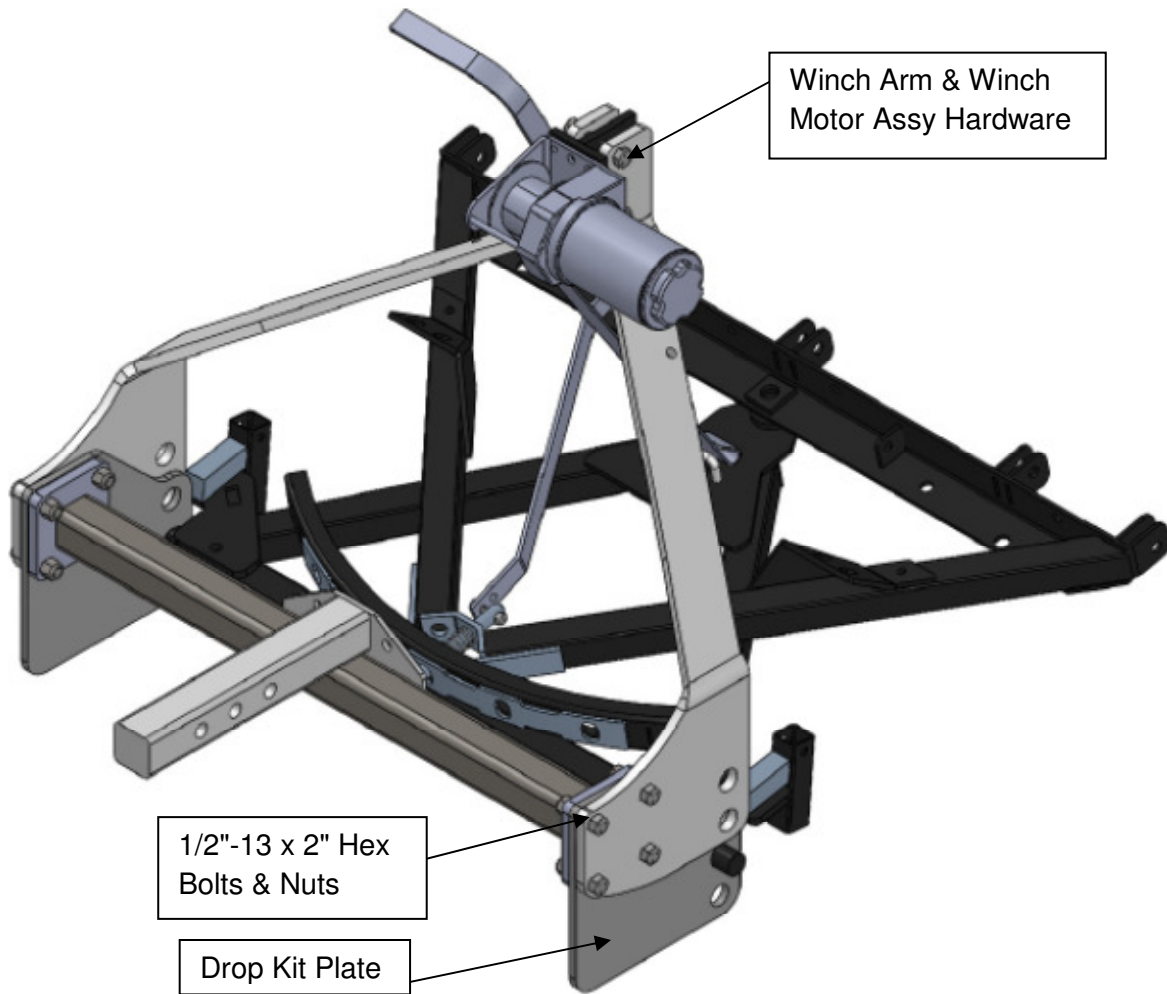

Drop Kit is installed and ready for use.